



Unified Communications Speakerphone

# YVC-300



User's Manual

Manuel de l'utilisateur

Benutzerhandbuch

Manuale dell'utente

Manual del usuario

Manual do usuário

Update the firmware and use the latest features.

You can download the latest firmware and user's manual from the following website:

<http://www.yamaha.com/products/en/communication/download/>

EN FR DE IT ES PT

# Contents

## Introduction

<b>Safety Precautions</b> .....	<b>2</b>
WARNING .....	2
CAUTION .....	3
<b>Precautions for Use</b> .....	<b>4</b>
Bluetooth® .....	4
<b>Introduction</b> .....	<b>7</b>
What is supplied in the box .....	7
Conventions used in this manual.....	7
Using the latest features .....	7
<b>What You Can Do with the Product</b> .....	<b>8</b>
<b>Controls and Functions</b> .....	<b>9</b>
Top .....	9
Side .....	11
Bottom .....	12

## How to use YVC-300

<b>Installing the Product</b> .....	<b>13</b>
<b>Connecting to Communication Equipment</b> .....	<b>14</b>
Connecting to a PC using the USB cable .....	14
Connecting to a Mac using the USB cable .....	18
Connecting to a smartphone or tablet via Bluetooth .....	21
Connecting to a videoconference system using audio cables .....	25

## Convenient functions

<b>Using Convenient Functions</b> .....	<b>27</b>
Adjusting the speaker volume .....	27
Muting the microphone .....	27
Muting the speaker .....	27
Accepting an incoming Bluetooth connection request/ending a call.....	28
Selecting a connected device on the EXT IN/OUT terminals.....	28
Enabling or disabling the Bluetooth function .....	28
Returning to the factory settings.....	29

## Others

<b>Troubleshooting</b> .....	<b>30</b>
Before contacting Yamaha .....	30
Q1 An indicator is off or flashing .....	30
Q2 Audio quality issues.....	30
Q3 Bluetooth connection issues.....	33
<b>Specifications</b> .....	<b>34</b>
General specifications .....	34
Audio specifications.....	34
<b>Customer Support</b> .....	<b>35</b>

## Safety Precautions

For the safe use of the product, make sure that you carefully read "WARNING" and "CAUTION" in this manual and follow them. The "WARNING" and "CAUTION" provided in this manual concern safe and appropriate use of the product, and are intended to prevent possible dangers to you and other third parties as well as any loss of property. Please ensure that you keep this manual so that a user of the product can refer to it at any time.

### **WARNING**

- Remove the USB cable immediately in any of the following cases:

- Any abnormal odor or noise occurs,
- Smoke is emitted,
- The product is broken, or
- The product has been exposed to water.

Using the product without taking any actions may result in fire or an electric shock.

Always contact your dealer for inspection and repair.

- Do not connect or disconnect any cables with wet hands. Failure to observe this may result in an electric shock or damage to the product.
- Do not touch terminals with your fingers or metal objects. Failure to observe this may result in an electric shock or damage to the product.
- Do not drop or apply strong impact to the product. Doing so may cause damage to parts inside the product, resulting in an electric shock, fire, or damage to the product.
- If the product is damaged, always contact your dealer for inspection and repair. Using the product without taking any actions may result in fire or an electric shock.
- Do not disassemble or modify the product in any way. Failure to observe this may result in fire, an electric shock, or damage to the product.
- Do not obstruct heat dissipation.
  - Do not cover the product with cloth or a tablecloth.
  - Do not place the product on a rug, carpet, or any other covering material for a floor.
  - Do not put the product into a small, poorly-ventilated space.

Failure to observe this may cause heat to be trapped inside the product, resulting in fire or damage to the product.
- Do not install the product outdoors or in wet environments. Failure to observe this may result in fire, an electric shock, or damage to the product.
- Do not install the product in an area with heavy dust or high humidity, oil soot or vapor, or corrosive gas. Failure to observe this may result in fire, an electric shock, or damage to the product.
- Do not place vases, flowerpots, glasses, cosmetics, chemicals, candles, and other objects on the product. Spilling water into the product or foreign objects entering inside the product may result in fire or an electric shock.
- Do not insert metal, paper, or other foreign objects into the product. Failure to observe this may result in fire, an electric shock, or damage to the product.
- Do not touch the product when you hear thunder. Failure to observe this may result in an electric shock.
- Ensure that you use the product at least 22 centimeters away from people with heart pacemakers, defibrillators, or other medical devices. Failure to observe this may affect the devices, resulting in serious accidents.
- Do not use the product near medical equipment. The radio waves may affect the electrical medical equipment. Avoid using the product in locations where the use of radio waves is prohibited, such as a place near medical equipment.

**⚠ CAUTION**

- Make sure that you use the supplied USB cable. Using a different USB cable may result in fire, an electric shock, or damage to the product.
- Do not damage the USB cable.
  - Do not place heavy objects on the cable.
  - Do not process the cable in any way.
  - Do not staple the cable.
  - Do not apply excessive force to the cable.
  - Keep the cable away from heat-generating appliances.

Failure to observe this may result in fire, an electric shock, or damage to the product.

- Do not install the product in an unstable location or a location that is exposed to vibration. It may fall or topple over, thus resulting in injury or damage to the product.
- Do not install the product in a location where it is exposed to direct sunlight or at extraordinarily high temperatures (for example, near a heater). Failure to observe this may result in damage to the product.
- Do not sit or stand on the product or place other objects on top of it. Failure to observe this may result in damage to the product.
- Turn down the volume to the minimum before starting playback. Failure to observe this may create a sudden loud noise, resulting in hearing impairment.
- Do not use the product in locations where the ambient temperature changes rapidly. Rapid changes in the ambient temperature may result in condensation on the product. Continued use of the product with condensation on it may result in damage to the product. If there is condensation on the product, make sure that you leave the product for a while until it dries off with the power turned off.
- Make sure that you remove static electricity from your body or clothing before touching the product. Failure to observe this may result in damage to the product due to the static electricity.
- Make sure that you route and connect the cables correctly. If the cables are pulled or someone gets caught in the cables, the product or connected equipment may tip over or fall, thus resulting in injury or damage to the product.
- Before connecting external equipment, thoroughly read the instruction manuals provided with the equipment and connect the equipment according to the instructions.
- Turn off the product and remove all the connection cables before moving the product. Failure to observe this may cause the product or connected equipment to fall or topple over, thus resulting in injury.

**WARNING**

TO REDUCE THE RISK OF FIRE OR ELECTRIC SHOCK, DO NOT EXPOSE THIS APPARATUS TO RAIN OR MOISTURE.

## Precautions for Use

- This product is intended for use in general offices and is not designed for use in any fields requiring a high degree of reliability, such as the handling of human lives or valuable assets.
- Note that Yamaha cannot assume any responsibility for any loss or damage resulting from improper use or misconfiguration of the product.
- Depending on the usage environment, the product may generate noise in telephones, radios, televisions, or other appliances. If this occurs, change the location where it is installed or its orientation.
- If you transfer this product to a third party, pass this manual and accessories along with it.
- Make sure that you follow the instructions of your local government when disposing of the product.
- Do not connect any equipment that generates noise on the same power line as the product.

### Bluetooth®

- Bluetooth is a technology for wireless communication employing the 2.4 GHz frequency band, which can be used without a license.
- The 2.4 GHz band used by Bluetooth-compatible devices is a radio band shared by many types of equipment. While Bluetooth-compatible devices use a technology to minimize the influence from other components using the same radio band, such influence may reduce the speed or distance of communications and in some cases interrupt communications.
- The speed or distance of communications differs according to the distance between the communicating devices, the presence of obstacles, radio wave conditions, and the type of equipment.
- Yamaha does not guarantee that all wireless connections between this product and devices compatible with the Bluetooth function.

**FCC INFORMATION (for US customers)****1 IMPORTANT NOTICE: DO NOT MODIFY THIS UNIT!**

This product, when installed as indicated in the instructions contained in this manual, meets FCC requirements. Modifications not expressly approved by Yamaha may void your authority, granted by the FCC, to use the product.

**2 IMPORTANT:** When connecting this product to accessories and/or another product use only high quality shielded cables. Cable/s supplied with this product **MUST** be used. Follow all installation instructions. Failure to follow instructions could void your FCC authorization to use this product in the USA.

**3 NOTE:** This product has been tested and found to comply with the requirements listed in FCC Regulations, Part 15 for Class "A" digital devices. Compliance with these requirements provides a reasonable level of assurance that your use of this product, in a commercial environment, will not result in harmful interference with other electronic devices. However, operation of this product in a residential area is likely to cause interference in some form. In this case you, the user, bear the responsibility of correcting this condition.

This product generates/uses radio frequencies and, if not installed and used according to the instructions found in the users manual, may cause interference harmful to the operation of other electronic devices. Compliance with FCC regulations does not guarantee that interference will not occur in all installations. If this product is found to be the source of interference, which can be determined by turning the product "OFF" and "ON", please try to eliminate the problem by using one of the following measures:

Relocate either the product generating the interference or the device that is being affected by the interference.

Utilize power outlets that are on different branch (circuit breaker or fuse) circuits or install AC line filter/s.

In the case of radio or TV interference, relocate/reorient the antenna. If the antenna lead-in is 300 ohm ribbon lead, change the lead-in to co-axial type cable.

If these corrective measures do not produce satisfactory results, please contact the local retailer that is authorized to distribute this type of product. If you can not locate the appropriate retailer, please contact Revolabs, Inc., 144 North Rd, Suite 3250 Sudbury, MA 01776

The above statements apply **ONLY** to those products distributed by Revolabs, Inc.

This device complies with part 15 of FCC Rules and Industry Canada's licence-exempt RSSs. Operation is subject to the following two conditions: (1) this device may not cause harmful interference, and (2) this device must accept any interference received, including interference that may cause undesired operation.

This transmitter must not be co-located or operated in conjunction with any other antenna or transmitter.

This equipment complies with FCC/IC radiation exposure limits set forth for an uncontrolled environment and meets the FCC radio frequency (RF) Exposure Guidelines and RSS-102 of the IC radio frequency (RF) Exposure rules. This equipment has very low levels of RF energy that it deemed to comply without maximum permissive exposure evaluation (MPE). But it is desirable that it should be installed and operated keeping the radiator at least 20cm or more away from person's body.

Warning: Operation of this equipment in a residential environment could cause radio interference.

We, Revolabs, Inc. (UK), hereby declare that this unit is in compliance with the essential requirements and other relevant provisions of Directive 1999/5/EC.

**Revolabs, Inc. (UK)**

190, High Street, Tonbridge, Kent, TN9 1BE, UK.

Tel: +44-1732-366-535



**Information for users on collection and disposal of old equipment:**



This symbol on the products, packaging, and/or accompanying documents means that used electrical and electronic products should not be mixed with general household waste.

For proper treatment, recovery and recycling of old products, please take them to applicable collection points, in accordance with your national legislation.

By disposing of these products correctly, you will help to save valuable resources and prevent any potential negative effects on human health and the environment which could otherwise arise from inappropriate waste handling.

For more information about collection and recycling of old products, please contact your local municipality, your waste disposal service or the point of sale where you purchased the items.

**For business users in the European Union:**

If you wish to discard electrical and electronic equipment, please contact your dealer or supplier for further information.

**Information on Disposal in other Countries outside the European Union:**

This symbol is only valid in the European Union. If you wish to discard these items, please contact your local authorities or dealer and ask for the correct method of disposal.

# Introduction

Thank you for purchasing Yamaha YVC-300. This product is a voice terminal for convenient teleconferencing and remote talks, when connected to communication equipment, such as a PC or Mac, a smartphone or tablet, and a videoconference system.

Please read this manual thoroughly before using the product for proper installation and connections. Keep this manual in a safe place so that it does not become lost.

- The contents of this manual apply to the latest specifications as of the publishing date. To obtain the latest manual, access the following website then download the manual file.  
<http://www.yamaha.com/products/en/communication/download/>
- No part of this manual may be reproduced or used in any form without permission of Yamaha.
- Yamaha shall not be liable for any loss of or damage to data resulting from use of the product. Also note that the warranty only covers physical damage to the product.

## What is supplied in the box

- Main unit (YVC-300) x1
- USB cable 3 m (9.8 ft) x1
- User's manual (this manual) x1

## Conventions used in this manual

### ■ Abbreviations

This manual uses the following abbreviations for the products below:

- Yamaha YVC-300: The product, this product
- Microsoft® Windows®: Windows
- Microsoft® Windows® 7: Windows 7
- Microsoft® Windows® 8.1: Windows 8.1
- Microsoft® Windows® 10: Windows 10
- Mac OS® X 10.8: Mac OS X 10.8
- Mac OS® X 10.9: Mac OS X 10.9
- Mac OS® X 10.10: Mac OS X 10.10
- Mac OS® X 10.11: Mac OS X 10.11

### ■ Trademarks

- Microsoft and Windows are registered trademarks of Microsoft Corporation in the United States and other countries.
- Macintosh and Mac OS are registered trademarks of Apple Inc.
- Android™ is a trademark or registered trademark of Google Inc.
- Bluetooth® is a registered trademark of the Bluetooth SIG and is used by Yamaha in accordance with a license agreement.
- NFC logo (N-Mark) is a trademark or registered trademark of NFC Forum, Inc.

## Using the latest features

Yamaha is making continual improvements in product features.

To make use of the latest features, visit the following website to download the firmware of the product: <http://www.yamaha.com/products/en/communication/download/>



## What You Can Do with the Product

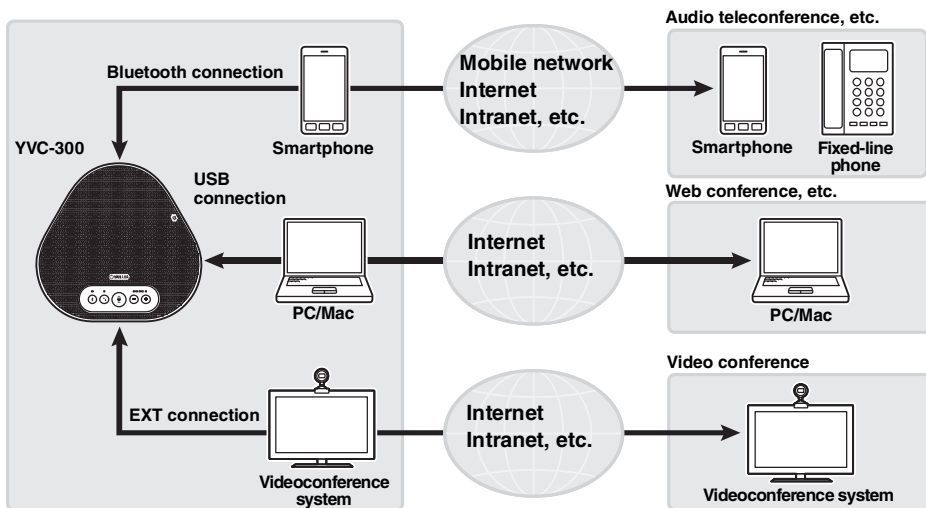

### ■ "Easy-to-talk" and "easy-to-hear" voice communications

The product is equipped with microphones with high voice-capturing capability and a speaker with high voice reproduction capability. It also provides high-performance audio signal processing functions, such as the adaptive echo canceller and noise reduction, providing "easy-to-talk" and "easy-to-hear" voice communications without skipping or noise.

### ■ Connection with various communication devices

The product provides three connection interfaces: "USB" for a connection with a PC or Mac, "Bluetooth" for a smartphone or tablet, and "EXT" for an analog connection with a videoconference system.

You can also use the "USB, Bluetooth, and EXT" interfaces at the same time (the audio mixer function enables this).

# Controls and Functions

## Top

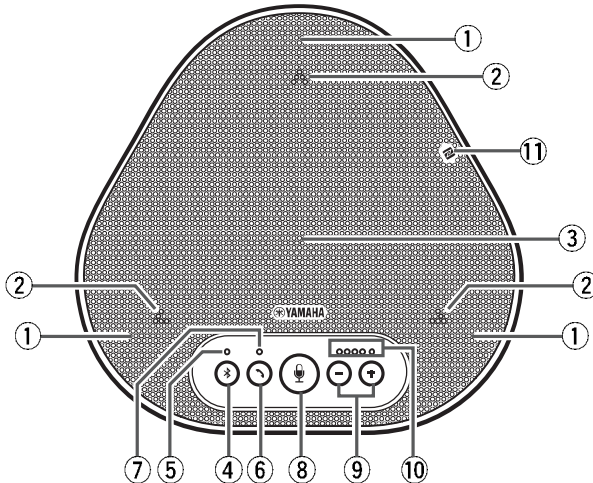

### Q Microphones

Picks up voice of people who are speaking.

### w Microphone indicators

Indicate the level of voice the microphone picks up. They also indicate incoming Bluetooth connection requests and a mode of the product. (→Page 10)

### e Speaker

Outputs voices from the remote party.

### r Bluetooth button (Ⓜ)

Press this button to pair the product with or connect the product to a Bluetooth-compatible smartphone or tablet.

Pressing the button while the product has an established connection with a Bluetooth device will end the connection. (→Page 21)

### t Bluetooth indicator

Indicates the product status in conjunction with the operation of the Bluetooth button. (→Page 11)

### y On/off-hook button (Ⓜ)

Allows you to take an incoming call or hang up a call while the product is connected to a Bluetooth-compatible smartphone or tablet. (→Page 28)

### u On/off-hook indicator

Indicates the product status in conjunction with the operation of the on/off-hook button. (→Page 11)

### i Microphone mute button (Ⓜ)

Used to temporarily turn off (mute) the microphone. The remote party can no longer hear you. (→Page 27)

### o Volume buttons (Ⓜ)

Press them to adjust the speaker volume. Holding down either of the buttons for at least 0.5 seconds allows you to continuously turn the volume up or down. (→Page 27) Also, when changing settings of the product, use this button. (→Page 28).

### ! Volume level indicator

Usually indicates the input level of voice from the remote party. It indicates the volume level of the speaker output when the speaker volume level is adjusted. It indicates a setting when it is changed. (→Page 10)

### ! NFC logo (N-Mark)

Holding a Bluetooth-compatible smartphone or tablet with the NFC (Near Field Communication) function over the logo allows it to be paired with, connected to, or disconnected from the product. (→Page 24)

■ How the volume level indicator (Page 9: ! D)works

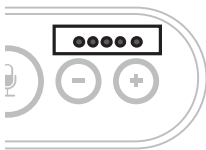

Status	Description	Example	
		(● : On, ○ : Off, ☼ : Flashing)	
Normal operation	The input level of incoming audio signals from the remote party is indicated.	○○○○○	No audio signal is present.
		●●●○○	Audio signals are present.
		●●●●●	Maximum audio signal input.
When the speaker volume is being adjusted (→Page 27)	The specified speaker volume level is indicated.	○○○○○	The speaker volume level is set to minimum.
		●●●○○	The speaker volume level is set to medium.
		●●●●●	The speaker volume level is set to maximum.
When the speaker is muted (→Page 27)	The indicator indicates that the speaker is muted.	☼●●●○	The indicator symbols at the current volume level will flash.
When the product is being started	The indicator indicates that the product is now starting.	●→○○○○ ← ○○○○●●	The illuminated symbols move back and forth until the product is completely started.

In addition to the above, the indicator indicates the setting of the product, as described in "Selecting a connected device on the EXT IN/OUT terminals" (page 28). Also, when an error occurs, it displays the details of the error. (→Page 30)

■ How the microphone indicators (Page 9: w) work

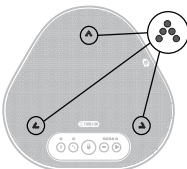

Status	Description
Normal operation	Lit in green. They light up brighter when the voice is input.
When the microphone is muted (→Page 27)	Flashes red.
When incoming Bluetooth connection requests are received (→Page 28)	Flashes green (red when the microphone is muted) (at 0.25-second intervals).

In addition to the above, the indicators flash white in various setting modes. (→Page 29)  
Also, when an error occurs, they flash red at high speed (at 0.1-second intervals). (→Page 30)

## ■ How the Bluetooth indicator (Page 9: t ) works

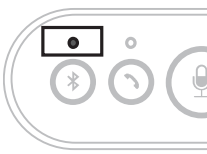

Indication	Status
Off	The Bluetooth function is disabled.
Flashing blue at high speed (at 0.25-second intervals)	The function is waiting for the pairing process to be done.
Flashing blue at slow speed (at 0.5-second intervals)	The Bluetooth function is waiting for the connection to be established.
Non-flashing blue light	The Bluetooth connection has been established.
Green light	The Bluetooth connection has not been established.

## ■ How the on/off-hook indicator (Page 9: u ) works



Indication	Status
Off	A Bluetooth connection is ended/the product is waiting for an incoming call.
Green light	A Bluetooth connection is in progress.

## Side

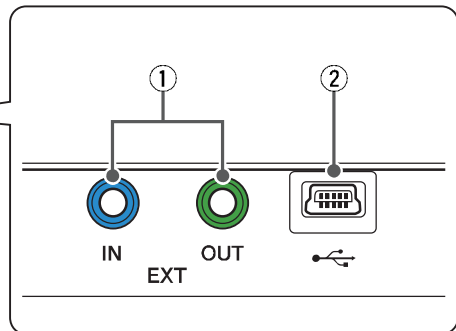
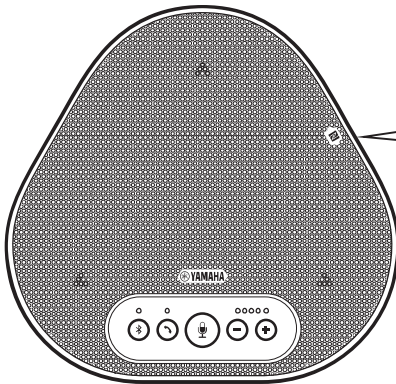

### q EXT IN/OUT terminals

Connect the terminals to the audio I/O terminals of a videoconference system. (→Page 25)

### w USB terminal

Use the supplied USB cable to connect this terminal to a PC or Mac for communication and for power supply.

When you connect this product to a product that does not supply power, such as a smartphone or a tablet, use a commercially available USB power adapter. No USB power adapter is supplied with this product.

## Bottom

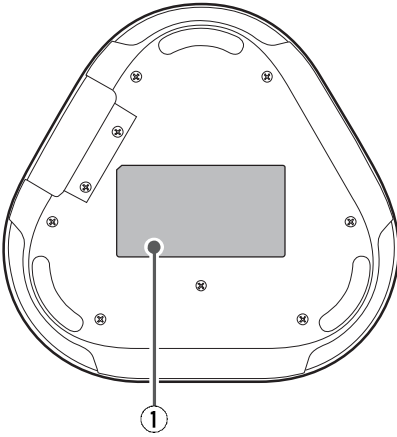

### Q **Nameplate**

Provides the following information:

**Model No.:** Provides the model number of the product.

**SERIAL LABEL:** Provides the serial number, which is used to manage and categorize the product.

## Installing the Product

Install the product in a location where you actually use it, such as a conference room.

### ■ Installation location

Locate a position where the product can pick up voices of participants well and the participants can hear audio from the speaker well to place the product there.

#### Note

Keep the product away from noise sources (such as heat radiation fans of PCs and Macs, and projectors). Otherwise, the remote party may have poor audio quality.

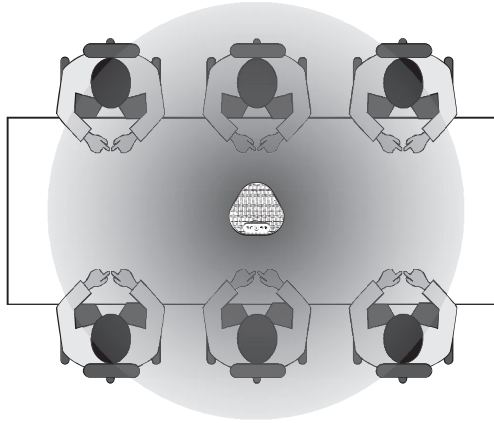

## Connecting to Communication Equipment

This chapter describes how to connect to each communication device.  
After the connection is established, check that sound is output correctly.

### Connecting to a PC using the USB cable

#### ■ Check the following before the connection procedure

Make sure that you have the supplied USB cable available.

In addition, the PC connected to the product must meet the following system requirements:

- OS: Windows 7 (32-bit/64-bit), Windows 8.1 (32-bit/64-bit), or Windows 10 (32-bit/64-bit)
- USB: USB 2.0 or later

#### Notes

- You cannot connect more than one microphone or speaker including this product to one PC and use them at the same time.
- Use the supplied USB cable only. Using a different USB cable may cause the product to malfunction.
- The product must be connected directly to a PC. Connecting the product via a USB hub may cause the product to malfunction.
- In rare cases, an audio playback may be interrupted due to PC usage, such as the workload or limited free space in memory.

#### ■ Connecting the devices

Connect between the product and a PC through the supplied USB cable.

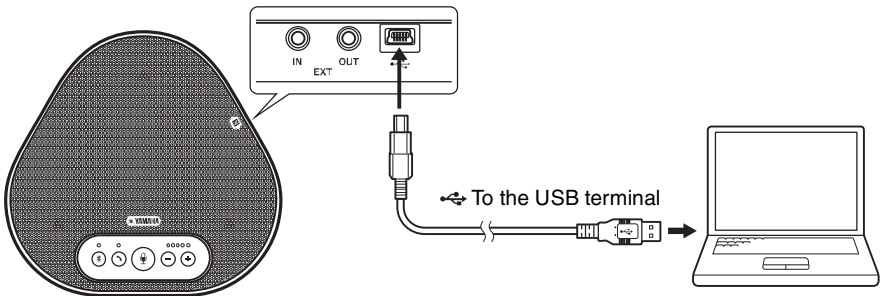

#### ☀ Tips

- The product receives power from the PC through the USB cable (USB bus powered).
- You do not need to install a separate USB driver because the PC recognizes the product as a standard USB audio device.

## ■ Checking that the connection has been made correctly

After the connection is established, perform the following steps to check that the PC recognizes the product correctly.

### Note

The items and options in the setting window may vary depending on your PC environment.

#### 1 Open the Control Panel on your PC.

- In Windows 7, click "Start" - "Control Panel".
- In Windows 8.1, or 10, right-click the bottom left corner of the Start screen, and then click "Control Panel".

#### 2 Click "Hardware and Sound" - "Sound".

The "Sound" window appears.

#### 3 Click the "Playback" tab.

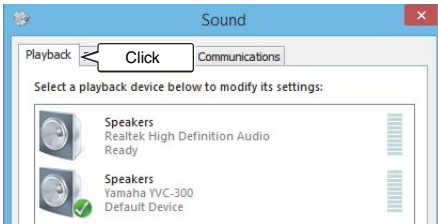

#### 4 Check that "Yamaha YVC-300" is set as a default device in the "Speakers" field.

If not, click "Yamaha YVC-300" and then click "Set Default".

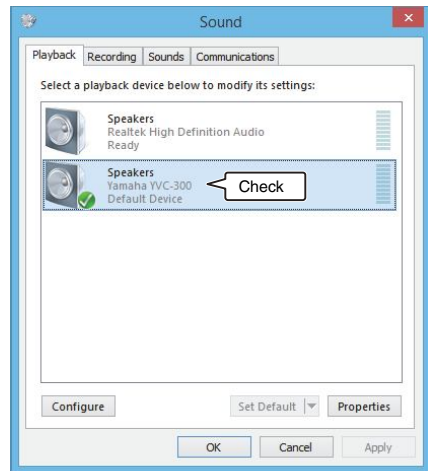

### 💡 Tip

In most cases, simply connecting the product to a PC automatically sets "Yamaha YVC-300" as a default device.

#### 5 Click the "Recording" tab.

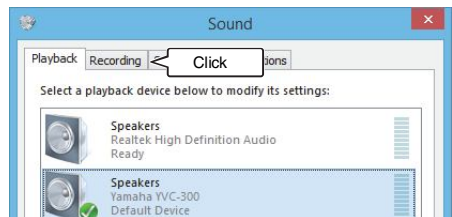



---

**6 Check that "Yamaha YVC-300" is set as a default device in the "Microphone" field.**

If not, click "Yamaha YVC-300" and then click "Set Default".

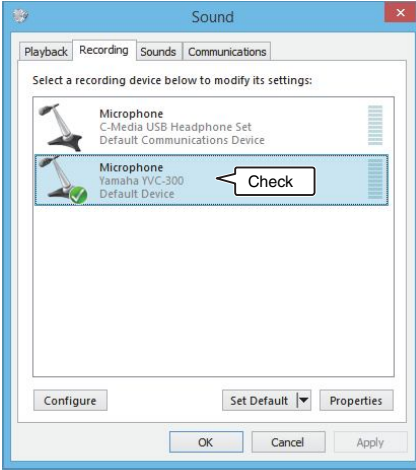

**Tip**

In most cases, simply connecting the product to a PC automatically sets "Yamaha YVC-300" as a default device.

---

**7 Click "OK" to close the "Sound" window.**

## ■ Adjusting the microphone sensitivity

Sound may be distorted or too faint on the remote party depending on your environment. In this case, adjust the microphone sensitivity.

### Note

The items and options in the setting window may vary depending on your PC environment.

#### 1 Open the Control Panel.

- In Windows 7, click "Start" - "Control Panel".
- In Windows 8.1, or 10, right-click the bottom left corner of the Start screen, and then click "Control Panel".

#### 2 Click "Hardware and Sound" - "Sound".

The "Sound" window appears.

#### 3 Click the "Recording" tab.

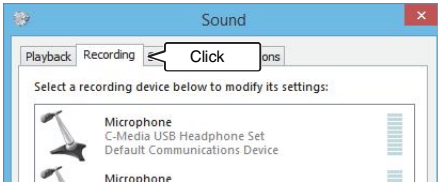

#### 4 Select "Yamaha YVC-300" from "Microphone" devices and then click "Properties".

The "Microphone Properties" window appears.

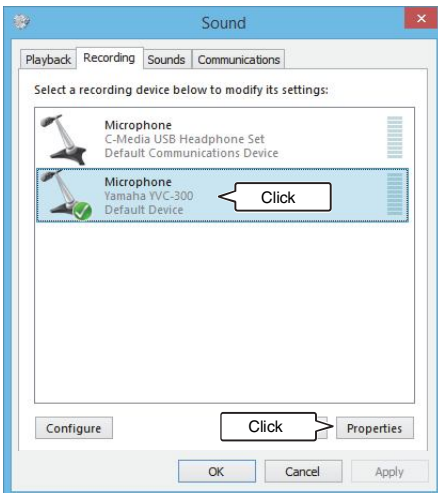

#### 5 Click the "Levels" tab.

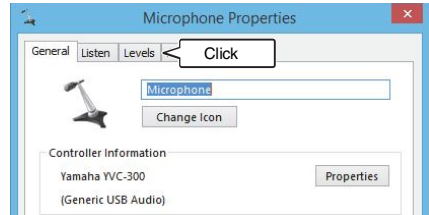

#### 6 In the "Microphone" section, adjust the microphone sensitivity.

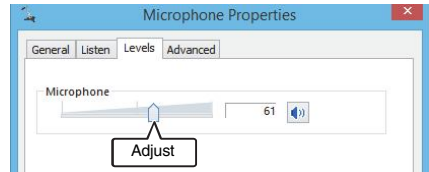

## Connecting to a Mac using the USB cable

### ■ Check the following before the connection procedure

Make sure that you have the supplied USB cable available.

In addition, the Mac connected to the product must meet the following system requirements:

- OS: Mac OS X 10.8, Mac OS X 10.9, Mac OS X 10.10, Mac OS X 10.11
- USB: USB 2.0 or later

### Notes

- You cannot connect and use more than one microphone or speaker including this product to one Mac at the same time.
- Use the supplied USB cable only. Using a different USB cable may cause the product to malfunction.
- The product must be connected directly to a Mac. Connecting the product via a USB hub may cause the product to malfunction.
- In rare cases, an audio playback may be interrupted due to Mac usage, such as the workload or limited free space in memory.

### ■ Connecting the devices

Connect between the product and a Mac through the supplied USB cable.

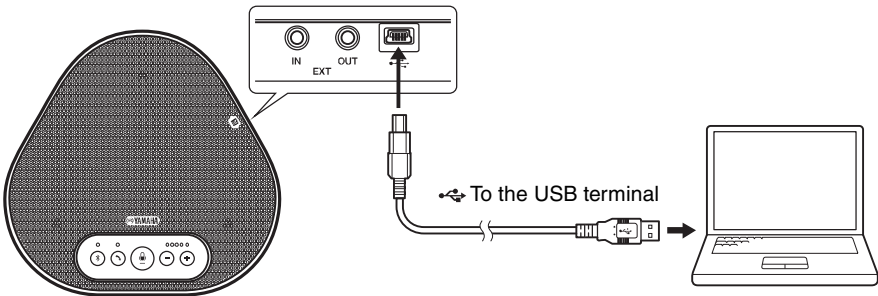

### 💡 Tips

- The product receives power from the Mac through the USB cable (USB bus powered).
- You do not need to install a separate USB driver because the Mac recognizes the product as a standard USB audio device.

## ■ Checking that the connection has been made correctly

After the connection is established, perform the following steps to check that the Mac recognizes the product correctly.

### Note

The items and options in the setting window may vary depending on your Mac environment.

**1 At the top left corner of the Mac desktop, click  and then click "System Preferences".**

**2 Click "Sound".**

The "Sound" window appears.



**3 Click the "Output" tab.**

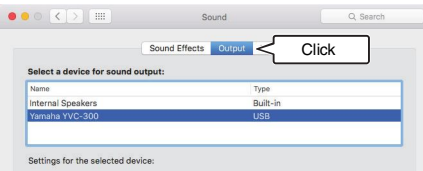

**4 In the "Select a device for sound output:" section, check that "Yamaha YVC-300" is selected.**

If not, click "Yamaha YVC-300".

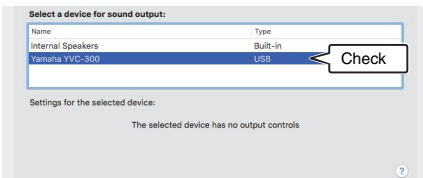

### Tip

In most cases, simply connecting the product to a Mac automatically selects "Yamaha YVC-300".

**5 Click the "Input" tab.**

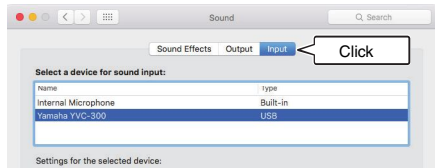

**6 In the "Select a device for sound input:" section, check that "Yamaha YVC-300" is selected.**

If not, click "Yamaha YVC-300".

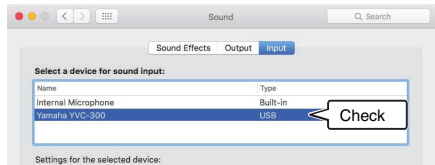

### Tip

In most cases, simply connecting the product to a Mac automatically selects "Yamaha YVC-300".

## ■ Adjusting the microphone sensitivity

Sound may be distorted or too faint on the remote party depending on your environment. In this case, adjust the microphone sensitivity.

### Note

The items and options in the setting window may vary depending on your Mac environment.

- 1 From  at the top left corner of the Mac desktop, select "System Preferences" - "Sound" - "Input" tab.
- 2 In the "Input volume" field, adjust the microphone sensitivity.

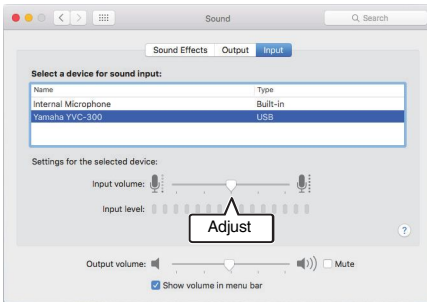

## Connecting to a smartphone or tablet via Bluetooth

### ■ Check the following before the connection procedure

Make sure that you have a Bluetooth-compatible smartphone or tablet (hereafter, collectively referred to as a "smartphone") available.

Also, make sure that you have one PC or Mac for power supply.

### Notes

- The smartphone must be within 10 m (32.8 ft) from the product (with no obstacles between them).
- There is no guarantee that the product can connect to any types or models of smartphones via Bluetooth.

### ☀ Tips

- Smartphones show the product as "YVC-300 Yamaha".
- Only one smartphone can connect to the product via Bluetooth at the same time.

### ■ Connecting to a power source

Use the supplied USB cable to connect between the product and a PC or Mac.  
The product receives power from the PC or Mac.

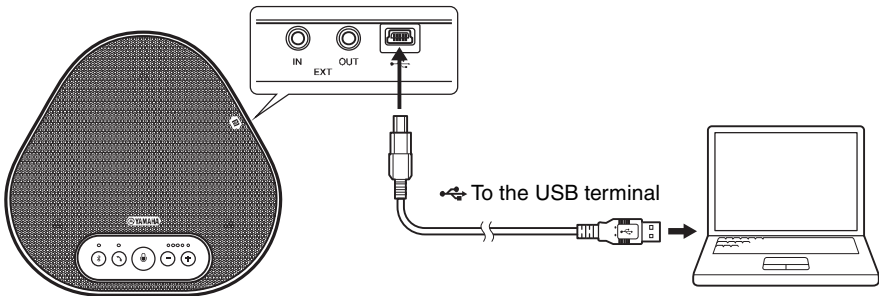

If the product is not connected to the PC or Mac, connect the supplied USB cable to a commercially available USB power adapter.

### Notes

- Make sure to first read the safety precautions for the USB power adapter you are going to use.
- Use the USB power adapter that is capable of supplying power compliant with the USB standard.  
Output voltage: 4.8 to 5.2 V  
Output current: At least 0.5 A

## ■ Pairing

Pairing is an operation where a smartphone and the product are registered with each other. When a Bluetooth connection is used for the first time or when pairing information is deleted, the pairing process is required.

Once a pairing is completed, you can make a Bluetooth connection in a simple procedure.

### ☀ Tips

- Check that the pairing is completed on the smartphone. If the pairing is not succeeded, retry it.
- If the power supply to the product is stopped during a pairing operation, the pairing information may be discarded. In this case, retry pairing.
- The product can be paired with up to eight smartphones. If a ninth smartphone is paired, the product deletes the pairing information on the device with the oldest Bluetooth connection date and time.
- If the product is connected to another smartphone via Bluetooth, disconnect it from the smartphone before pairing.

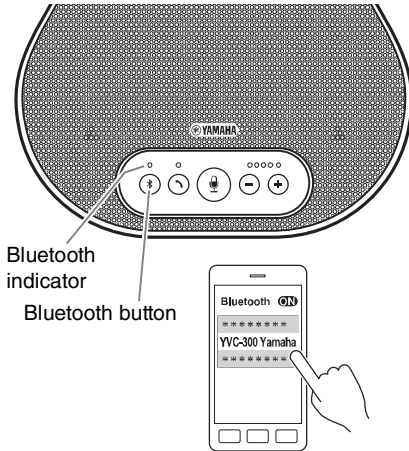

---

### 1 Press and hold the Bluetooth button ( ) for at least 2 seconds.

The Bluetooth indicator now flashes blue at high speed, indicating that the product is ready for pairing.

---

### 2 Perform a pairing operation on the smartphone.

If a message prompts you to enter your passkey, enter "0000" in figures.

### ☀ Tip

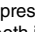
If you press the Bluetooth button (  ) while the Bluetooth indicator is flashing blue at high speed, or if 90 seconds elapses without the pairing being completed, the product is no longer ready for the pairing.

## ■ Making a Bluetooth connection with the paired smartphone

### Tip

Some smartphones make Bluetooth connections simultaneously with their pairing. In such a case, the procedure below is not required.

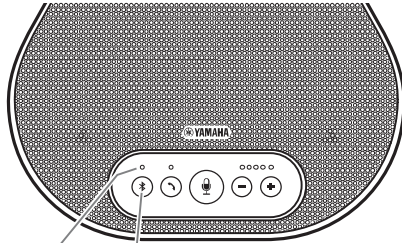

Bluetooth indicator

Bluetooth button

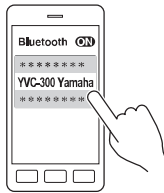

### 1 Press the Bluetooth button ( ).

The Bluetooth indicator now flashes blue, indicating that the product is ready for a Bluetooth connection.

### 2 Make a Bluetooth connection on the paired smartphone.

When the connection is established, the Bluetooth indicator now lights up blue. Also, a notification sound rings to let the user know that the Bluetooth connection has been established.

### Tip

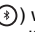
If you press the Bluetooth button (  ) while the Bluetooth indicator is flashing blue, or if 90 seconds elapses without the Bluetooth connection established, the product is no longer ready for the Bluetooth connection.



## ■ Making a pair and Bluetooth connection using the NFC function (for NFC-compatible models)

Any of the following smartphone models (hereafter, referred to as an "NFC-compatible model") offers an easy pairing and Bluetooth connection.

- NFC-compatible Android devices: versions 4.1, 4.2, 4.3, 4.4, and 5.0

Before starting the procedure below, turn on the NFC function of the smartphone.

### Note

The function may not work or the connectable distance may be different depending on smartphones.

### Tips

- If the smartphone is in a case, remove it.
- If a pairing or Bluetooth connection does not work well, hold the smartphone differently over the product.

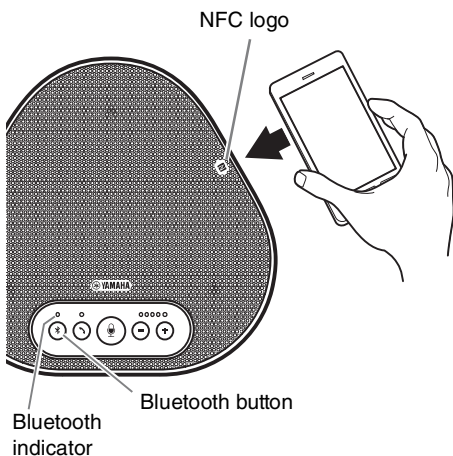

### 1 Press the Bluetooth button ( ).

The Bluetooth indicator now flashes blue, indicating that the product is ready for a Bluetooth connection.

### 2 Hold the smartphone over the NFC logo on the product.

When the connection is established, the Bluetooth indicator now lights up blue. Also, a notification sound rings to let the user know that the Bluetooth connection has been established.

### Tip

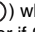
If you press the Bluetooth button (  ) while the Bluetooth indicator is flashing blue, or if 90 seconds elapses without the Bluetooth connection established, the product is no longer ready for the Bluetooth connection.

## ■ Disconnecting a Bluetooth connection

To disconnect a Bluetooth connection while the connection is made, perform one of the following operations:

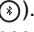
- Press the Bluetooth button (  ).
- Perform the Bluetooth disconnection procedure on the smartphone.
- Hold the smartphone over the NFC logo on the product (for NFC-compatible models).

When a Bluetooth connection is disconnected, the Bluetooth indicator now lights up green. Also, a notification sound rings to let the user know that the Bluetooth connection has been disconnected.

## Connecting to a videoconference system using audio cables

### ■ Check the following before the connection procedure

Make sure that you have two audio cables available for input and output.  
Also, make sure that you have one PC or Mac for power supply.



### Tip

Different models of videoconference systems may have different shapes of audio input and output terminals. Use audio cables with their connector shapes that match the shapes of the audio input and output terminals of your videoconference system. The product must be connected to a stereo mini plug, regardless of the type of the plug connected to the videoconference system.

### ■ Connecting to a power source

Use the supplied USB cable to connect between the product and a PC or Mac.  
The product receives power from the PC or Mac.

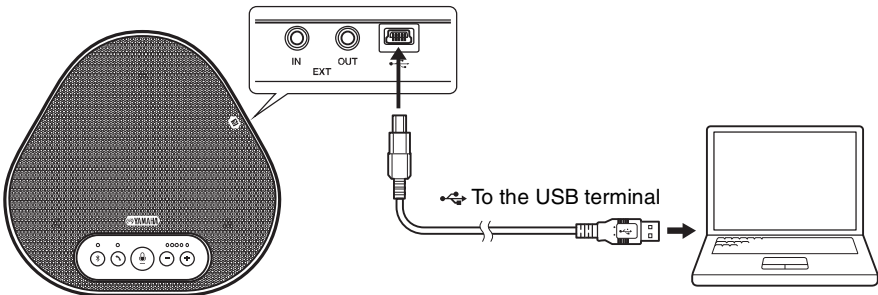

If the product is not connected to the PC or Mac, connect the supplied USB cable to a commercially available USB power adapter.

### Notes

- Make sure to first read the safety precautions for the USB power adapter you are going to use.
- Use the USB power adapter that is capable of supplying power compliant with the USB standard.  
Output voltage: 4.8 to 5.2 V  
Output current: At least 0.5 A

### ■ Setting up the EXT IN/OUT terminals function

Follow the steps in "[Selecting a connected device on the EXT IN/OUT terminals](#)" (page 28), switch the mode of the EXT IN/OUT terminals to the "Videoconference system" in advance.

### ■ Connecting to a videoconference system

Use audio cables to connect between the product and the videoconference system. The following figure shows an example of using RCA pin plugs for the audio input/output terminals on the videoconference system.

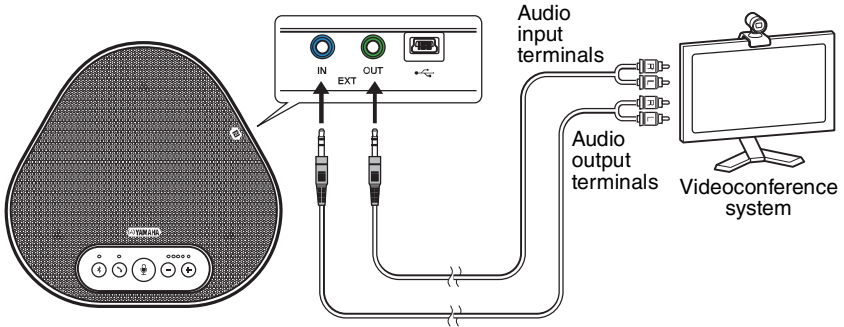

#### Note

If two products are connected for use, they cannot be connected to a videoconference system.

### ■ Changing settings of the videoconference system

Change audio input/output settings of the videoconference system, so that the product can serve as a microphone and speaker for that system.

#### Note

Make sure that you disable the microphone and speaker of the videoconference system.



# Using Convenient Functions

This chapter describes convenient functions provided by the product.

## Adjusting the speaker volume

You can adjust the output volume of the speaker (voices from the remote party) by pressing the volume buttons (⊖ ⊕). When you press the volume button, the volume level indicator shows the volume level.

Every time you press either of the buttons, the volume is turned up or down in a step-by-step manner. Holding down the button for at least 0.5 seconds will cause the volume level to be changed continuously.

Example ( ● : On, ○ : Off)	
	The speaker volume level is set to minimum.
	The speaker volume level is set to maximum.

### Note

Adjust the speaker volume level so that the sound is not distorted. If the sound is distorted, the remote party may hear echoes.

### Tip

If a PC or Mac is connected through a USB cable, changing the speaker volume level on the PC or Mac will also change the speaker volume level of the product according to the volume level of the PC or Mac.

## Muting the microphone

Temporarily turn off the microphone so that the remote party cannot hear you.

### ■ Muting the microphone

Press the microphone mute button (Ⓜ). The microphone indicator now flashes red, causing the microphone to be muted.

### ■ Unmuting the microphone

When the microphone is muted, press the microphone mute button (Ⓜ). The microphone indicator now lights up green, causing the microphone to be unmuted.

## Muting the speaker

Temporarily turn off the speaker so that you cannot hear the remote party.

The speaker can be muted only when the PC or Mac is connected through the USB cable.

### ■ Muting the speaker

Use the PC or Mac to mute the speaker (output).

The volume level indicator now flashes green with the current volume level displayed, causing the speaker to be muted.

### ■ Unmuting the speaker

When the speaker is muted, use the PC or Mac to unmute the speaker (output).

The volume level indicator now stops flashing, causing the speaker to be unmuted.

### Tip

You can unmute the speaker by pressing either of the volume buttons (⊖ ⊕).

## Accepting an incoming Bluetooth connection request/ ending a call

The product can work with the phone function of the Bluetooth-connected smartphone.

### ■ Taking an incoming call

When the Bluetooth-connected smartphone gets an incoming call, the microphone indicator flashes green (red if the microphone is muted) (at 0.25-second intervals).

By pressing the on/off-hook button (Ⓢ) while the incoming call is received, you can talk with the remote party through the microphone and speaker of the product. The on/off-hook indicator lights up green during the call.

#### Note

Some smartphones may enable the microphone and speaker on them after they get an incoming call. To resolve this situation, select YVC-300 in the audio source settings of the smartphone to enable the microphone and speaker of the product.

### ■ Ending a call

Press the on/off-hook button (Ⓢ) during a call. The on/off-hook indicator turns off and the call is ended.

## Selecting a connected device on the EXT IN/OUT terminals

Based on the device to be connected to the EXT IN/OUT terminals on the product, follow the steps below to switch the setting:

### 1 Press and hold the both volume buttons (⊖ ⊕) simultaneously for at least 2 seconds.

A notification sound rings, and the microphone indicator flashes white.

### 2 Press the volume button (⊖ ⊕) and set the volume level indicator display so that the device to be connected is selected.

Example (● : On, ○ : Off)	
●○○○○○	No connected device
○○●○○○	Videoconference system

#### Tip

The factory setting is set to "no connected device".

### 3 Press and hold the both volume buttons (⊖ ⊕) simultaneously for at least 0.5 seconds.

A notification sound rings when the setting is applied. The microphone indicator goes back to the previous state, lighting up green or flashing red.

## Enabling or disabling the Bluetooth function

When not using a Bluetooth connection, you can disable the Bluetooth function. To use a Bluetooth connection again, enable the Bluetooth function.



### 1 Press and hold the both volume buttons (⊖ ⊕) simultaneously for at least 2 seconds.

A notification sound rings, and the microphone indicator flashes white.

### 2 Press the Bluetooth button (Ⓢ) to enable or disable the function.

The Bluetooth indicator that lights up green indicates that the function is enabled, and the indicator that is off indicates that the function is disabled.

---



**3 Press and hold the both volume buttons (   ) simultaneously for at least 0.5 seconds.**

A notification sound rings when the setting is applied. The microphone indicator goes back to the previous state, lighting up green or flashing red.

## Returning to the factory settings

Return the settings of the product to the factory settings.

---

**1 Press and hold the both volume buttons (   ) simultaneously for at least 2 seconds.**

A notification sound rings, and the microphone indicator flashes white.

---

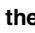
**2 Press and hold the on/off-hook button (  ) and the volume - button (  ) simultaneously for at least 2 seconds.**

A notification sound rings. The volume level indicator lights up green, the illuminated symbols moving back and forth. The other indicators turn off.

---

**3 When the volume level indicator turns off and is in the started-up state, the product now has the factory settings.**

### Tip

Returning the product to the factory settings will clear various settings, such as Bluetooth pairing information. Reconfigure the settings as necessary.

# Troubleshooting

## Before contacting Yamaha

Read this manual to check whether the problem can be resolved.

If the problem still continues, please contact the retailer or dealer who you purchased the product from.

## Q1 An indicator is off or flashing

Symptom	Cause	Action
The product looks turned off.	The USB cable is disconnected (if all the indicators are off).	Make sure that you securely connect the USB cable to the PC or Mac. (→Page 14, Page 18)
You cannot hear the remote party.	The product has not started up yet (if the lights are moving back and forth on the volume level indicator).	Wait for the product to start up. (→Page 10)
	The product is in setup mode (if the microphone indicator is flashing white).	Exit the setup mode. (→Page 28)
An error occurred (if the microphone indicator is flashing red at high speed).	A firmware update failed (if only the second volume level indicator from the left lights up green).	Retry the firmware update.
	A software or hardware failure occurred (if the volume level indicator lights up green in any other pattern).	Make a request to repair the product.

## Q2 Audio quality issues

Symptom	Cause	Action
You cannot hear the remote party.	The speaker is muted.	Unmute the speaker. (→Page 27)
	The speaker volume is set to the minimum.	Turn up the speaker. (→Page 27)
	On the PC or Mac connected via USB, a speaker other than YVC-300 is selected for the call application.	Select YVC-300 in the speaker device settings of the call application.
You cannot hear the remote party.	The microphone on the remote party is muted.	Ask the remote party to unmute their microphone.
	The microphone sensitivity on the remote party is set to the minimum.	Ask the remote party to increase the microphone sensitivity.

Symptom	Cause	Action
The remote party cannot hear you.	Your microphone is muted.	Unmute your microphone. (→Page 27)
	The microphone sensitivity of the PC or Mac connected via USB is set to the minimum.	Increase the microphone sensitivity on that machine. (→Page 17, Page 20)
	On the PC or Mac connected via USB, a microphone other than YVC-300 is selected for the call application.	Select YVC-300 in the microphone device settings of the call application.
	The speaker on the remote party is muted.	Ask the remote party to unmute their speaker.
	The speaker volume on the remote party is set to the minimum.	Ask the remote party to turn up their speaker.
You hear echoes.	The remote party has a problem with their device configuration or operating environment.	-
The remote party hear echoes or howling noises.	The PC or Mac connected via USB does not recognize the product properly.	Verify that the PC or Mac is configured properly. (→Page 15, Page 19)
	On the PC or Mac connected via USB, a speaker and microphone other than YVC-300 are selected for the call application.	Select YVC-300 in both the speaker and microphone device settings of the call application.
	Even though a videoconference system is connected to the EXT IN/OUT terminals, the connected device setting is set to "no connected device".	Change the connected device setting to "Videoconference system". (→Page 28)
	A videoconference system with substantial delay and distortion is connected to the EXT IN/OUT terminals.	Use a videoconference system with a little delay and distortion.
	The product is installed near a wall.	Install the product away from any wall.
	Objects are placed near the product.	Do not place any object around the product if possible.
	The product is used in a room with large reverberations.	<ul style="list-style-type: none"> <li>Place an object with high sound absorption in the room, away from the front of the microphone.</li> <li>To reduce the reverberations, turn down the speaker. (→Page 27)</li> </ul>



Symptom	Cause	Action
You hear noise.	The remote party has a problem with their device configuration or operating environment.	-
The remote party hears noise.	The product has a device that generates noise near it.	Keep the product as far away from noise sources as possible.
	The product is installed in a noisy room.	If any device is generating noise, turn it off.
Sound is distorted.	A videoconference system connected to the EXT IN terminal has a high output level.	Decrease the output level of the videoconference system.
	The microphone sensitivity on the remote party is high.	Ask the remote party to reduce their microphone sensitivity.
Sound is distorted on the remote party.	Your microphone has a high input level.	Take the product away from people who are talking.
	The microphone sensitivity of the PC or Mac connected via USB is high.	Reduce the microphone sensitivity. (→Page 17, Page 20)
	A videoconference system connected to the EXT OUT terminal does not provide a line-level input.	Connect a videoconference system that supports a line-level input.
	A videoconference system connected to the EXT OUT terminal has a high output volume.	Turn down the volume on the videoconference system.
	The speaker volume on the remote party is high.	Ask the remote party to turn down their speaker.
The volume on the remote party is low.	The microphone sensitivity of the PC or Mac connected via USB is low.	Increase the microphone sensitivity on that machine. (→Page 17, Page 20)
	A videoconference system connected to the EXT OUT terminal has a low output volume.	Turn up the volume on the videoconference system.

### Q3 Bluetooth connection issues

Symptom	Cause	Action
The product cannot pair with a smartphone via Bluetooth.	The Bluetooth function is disabled (if the Bluetooth indicator is off).	Enable the Bluetooth function. (→Page 28)
	The smartphone you are trying to pair with the product has pairing information for a different YVC-300.	Delete the pairing information for the different YVC-300 from the smartphone, and then pair with the desired YVC-300. (→Page 21)
The product cannot connect to a smartphone via Bluetooth.	The Bluetooth function is disabled (if the Bluetooth indicator is off).	Enable the Bluetooth function. (→Page 28)
	The product is not paired with the smartphone via Bluetooth (if the Bluetooth indicator lights up green).	Pair with the smartphone. (→Page 21)
	A different smartphone is connected to the product via Bluetooth (if the Bluetooth indicator lights up blue).	Disconnect the connection with the different smartphone, and then connect to the desired smartphone. (→Page 24, Page 21)
You cannot hear the remote party from the speaker through the smartphone.	The Bluetooth function is disabled (if the Bluetooth indicator is off).	Enable the Bluetooth function, and then connect the smartphone to the product. (→Page 28, Page 21)
	The smartphone is not connected via Bluetooth (if the Bluetooth indicator lights up green).	Connect the smartphone to the product. (→Page 21)
	YVC-300 is not selected in the audio source settings of the smartphone.	Select YVC-300 in the audio source settings of the smartphone. (→Page 28)

# Specifications

## General specifications

<b>External interface:</b>	USB 2.0 Full Speed, Bluetooth, NFC (Near Field Communication), EXT IN/OUT (stereo mini plug)
<b>Maximum power consumption:</b>	2.5W
<b>Operating environment:</b>	Temperature: 0 to 40 °C (32 to 104 °F) Humidity: 20 to 85% (no condensation)
<b>Storage environment:</b>	Temperature: -20 to +50 °C (-4 to 122 °F) Humidity: 10 to 90% (no condensation)
<b>Dimensions:</b>	235 (W) x 46 (H) x 226 (D) mm (9.3 (W) x 1.8 (H) x 8.9 (D) in)
<b>Weight:</b>	0.8 kg (1.8 lb)
<b>Power source:</b>	USB bus powered
<b>PC environment:</b>	OS: Windows 7 (32-bit/64-bit), Windows 8.1 (32-bit/64-bit), or Windows 10 (32-bit/64-bit) USB: USB 2.0 or later
<b>Mac environment:</b>	OS: Mac OS X 10.8, Mac OS X 10.9, Mac OS X 10.10, Mac OS X 10.11 USB: USB 2.0 or later
<b>Bluetooth:</b>	Bluetooth specification version: 2.1 + EDR Supported profiles: HFP (1.6), A2DP Supported codecs: SBC, mSBC, CVSD Wireless output: Class 2 Maximum communication distance: 10 m (32.8 ft) (no obstacles)
<b>NFC:</b>	Compatible devices: NFC-compatible Android devices versions 4.1, 4.2, 4.3, 4.4, and 5.0
<b>Accessories:</b>	USB cable 3 m (9.8 ft), User's Manual
<b>Others:</b>	Firmware update (transferred from a PC/Mac through USB)

## Audio specifications

<b>Microphone unit:</b>	Unidirectional microphones x3
<b>Speaker unit:</b>	Full-range speaker x1
<b>Frequency bandwidth for sound pickup:</b>	100 to 20,000 Hz
<b>Frequency bandwidth for playback:</b>	190 to 20,000 Hz
<b>Signal processing:</b>	Adaptive echo canceller, Noise reduction, Automatic tracking, Automatic gain control, Dereverberation

## Customer Support

For any questions and inquiries regarding this product, please access the following web site.

■ **Contact page**

<http://www.yamaha.com/products/en/communication/support/>